

## Cheval Flush Mount

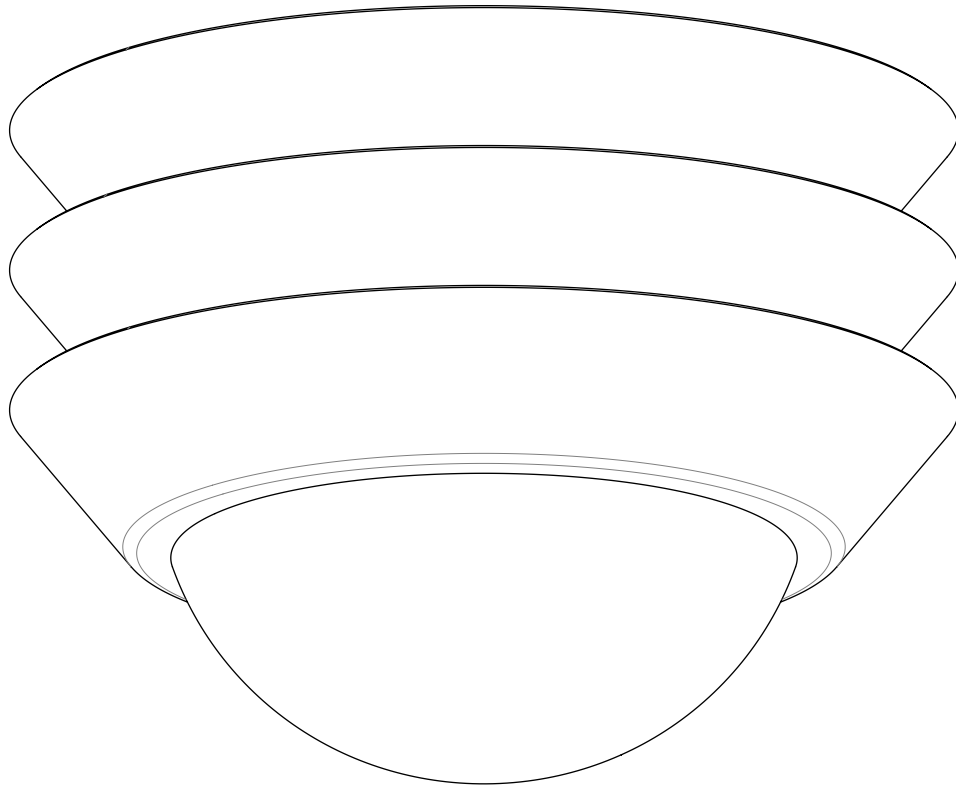

## Cheval Flush Mount Contents

Remove all parts from box onto a clean, soft surface and inspect for defects or damage.

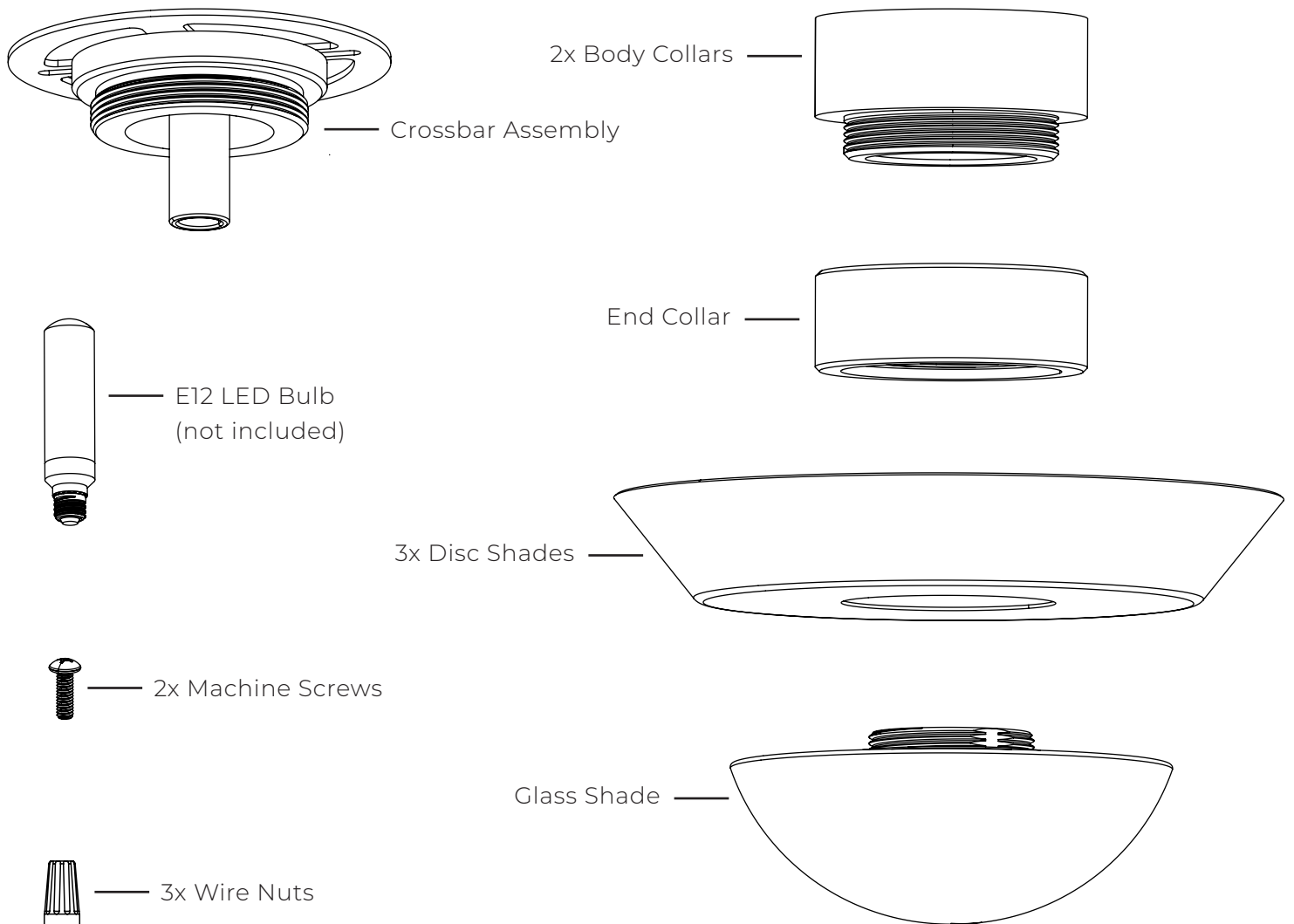

1. Connect the fixture ground wire to the ceiling ground wire. Connect the +/- fixture wires to the +/- ceiling wires.
2. Attach the crossbar assembly to the j-box using the 2x machine screws, making sure to tuck the wires and wire nuts inside the j-box.
3. Thread the E12 LED bulb (not included) into the socket.

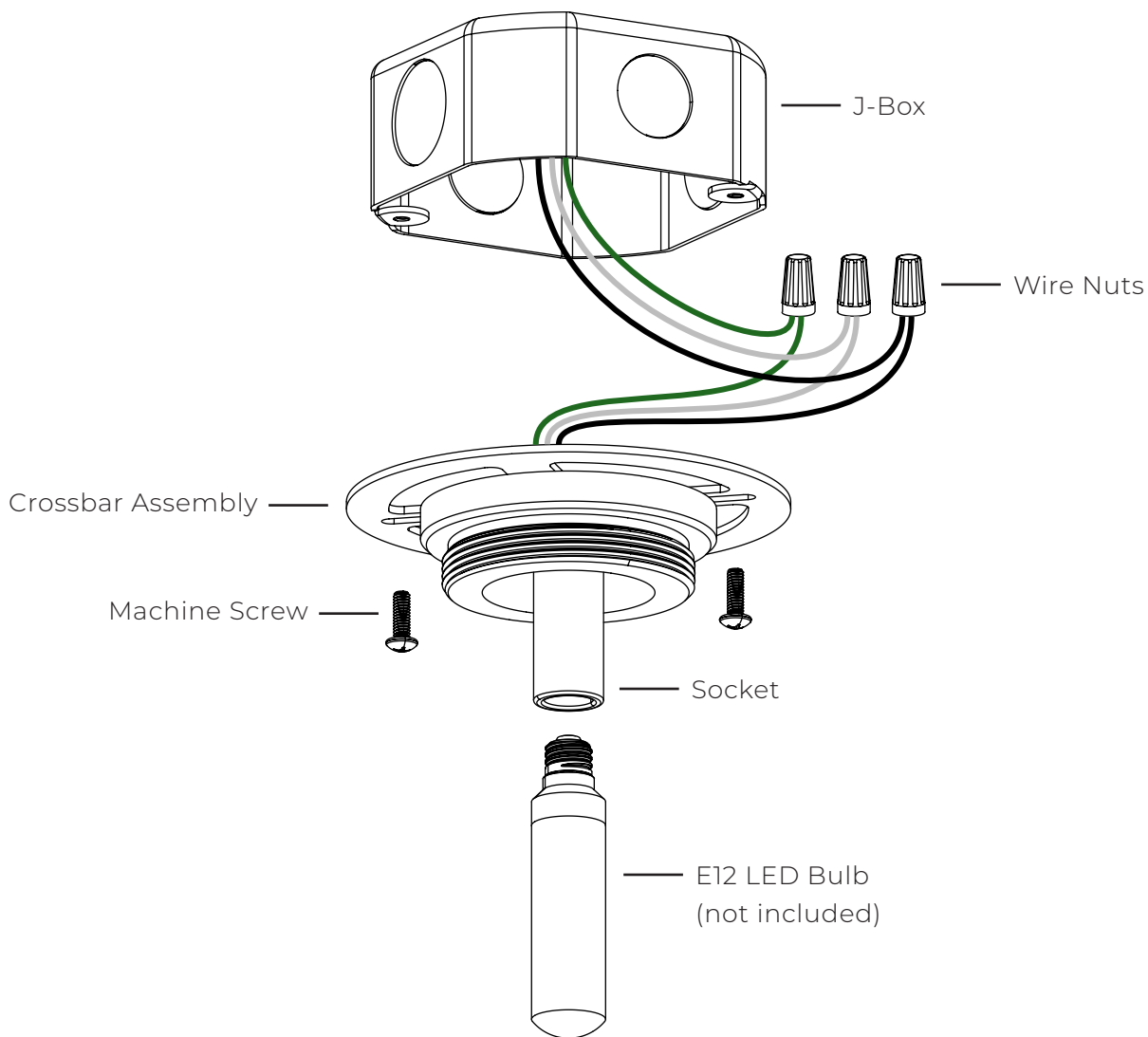

4. Thread 1x body collar onto the crossbar assembly. Slide 1x disc shade up and thread 1x more body collar on to fasten. Slide another disc shade up and thread on the end collar to fasten.

5. Slide the last disc shade up and thread on the glass shade to fasten.

