

## Paloma

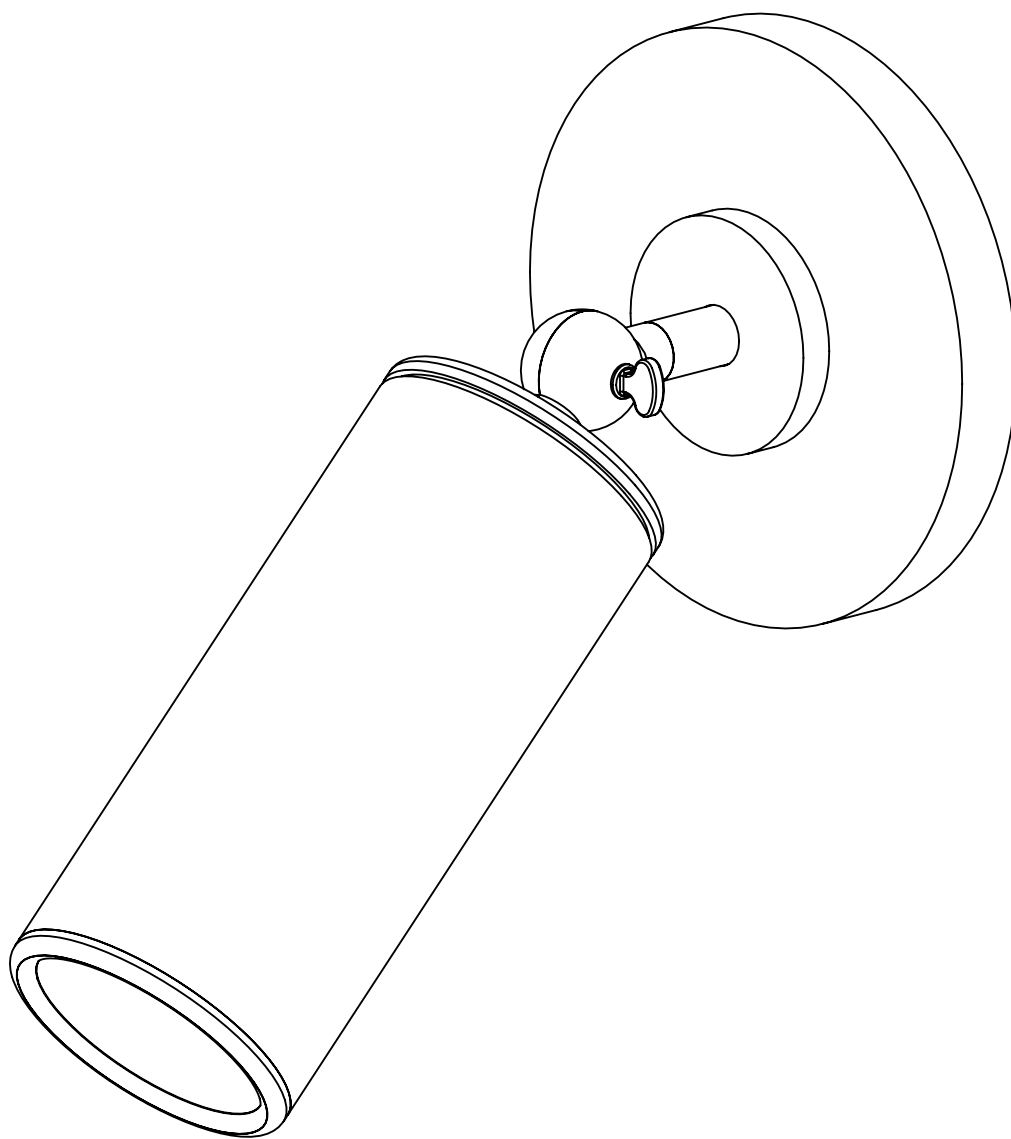

## Paloma Contents

Remove all parts from box onto a clean, soft surface and inspect for defects or damage.

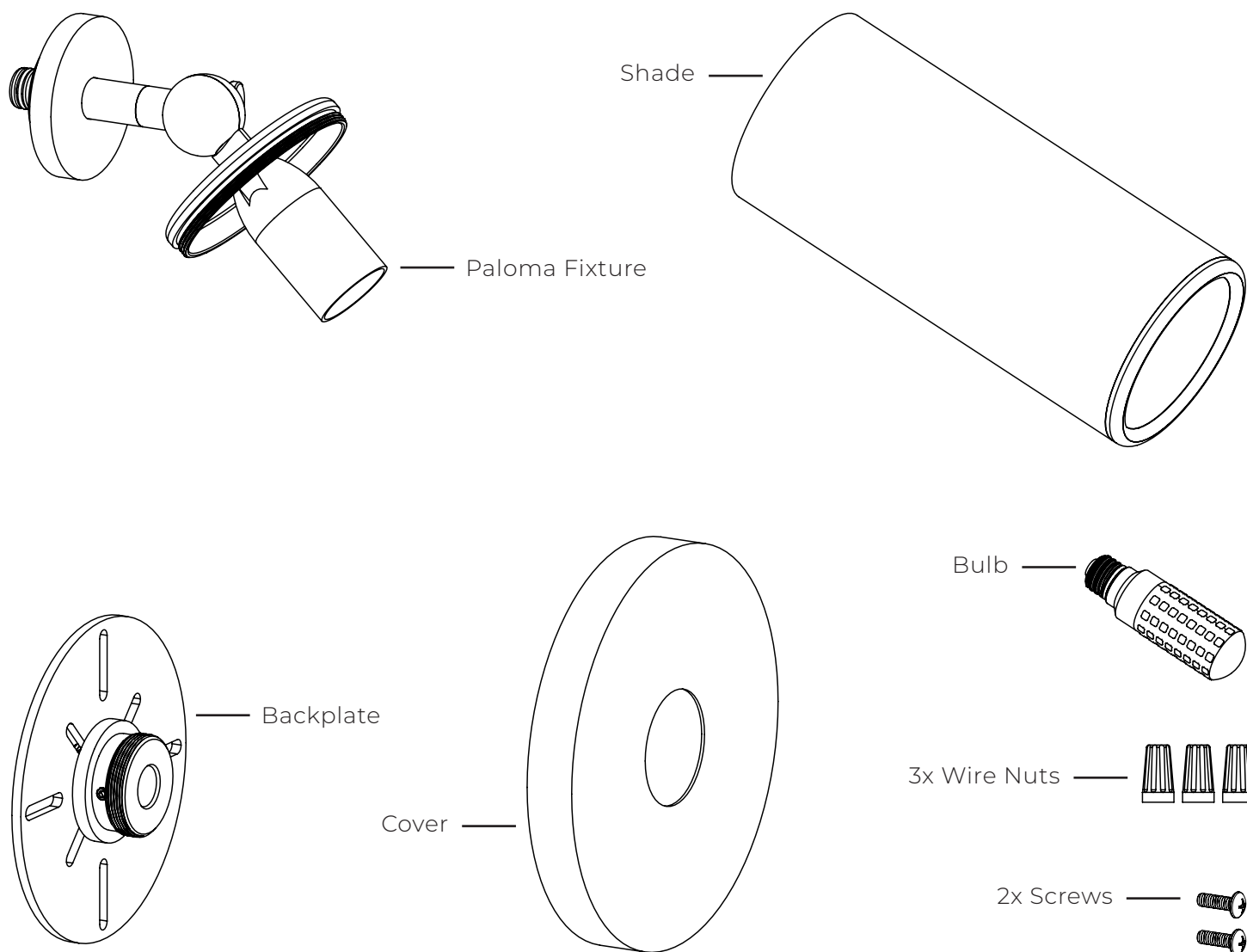

1. Feed the Paloma fixture wires through the collar, cover, and backplate as shown below.
2. Connect the fixture ground wire to the wall ground wire.
3. Connect the +/- fixture wires to the +/- wall wires. Tuck all wires into the j-box.
4. Mount the backplate to the j-box with the 2x screws.

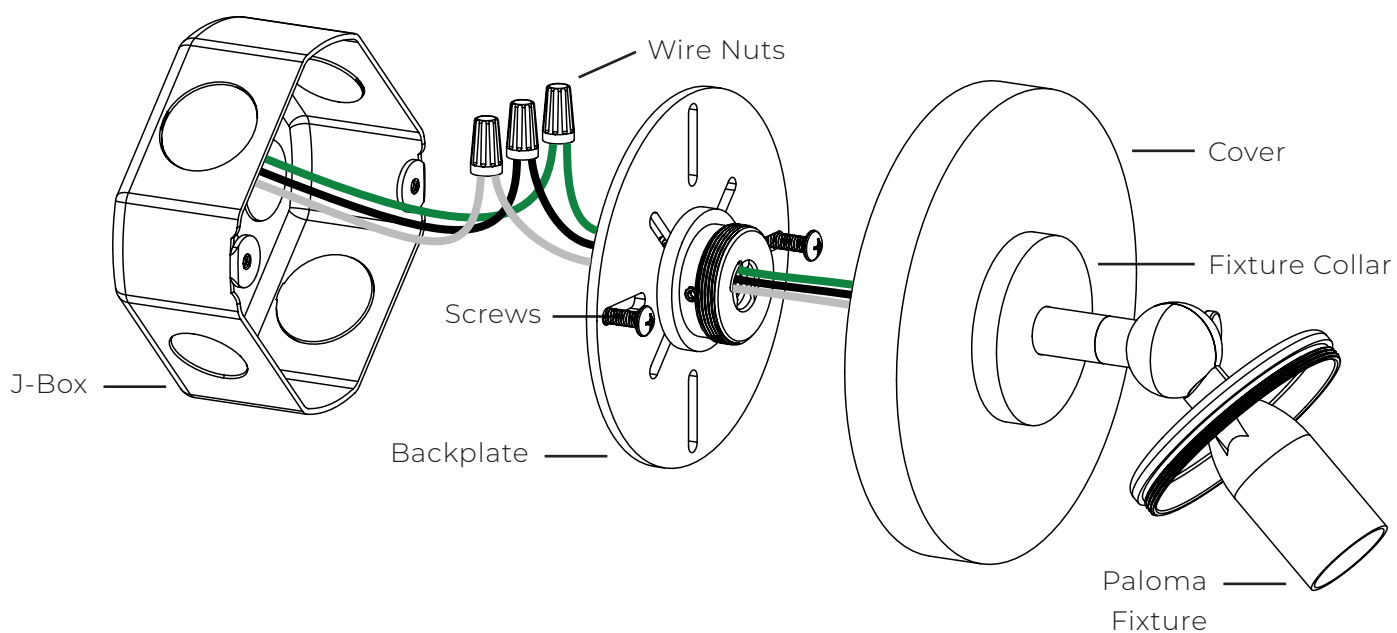

5. Push the fixture arm into the center hole of the backplate collar.
6. Set the left-to-right rotation angle of the Paloma fixture and tighten the set screw to lock the angle. To leave this rotation adjustable, do not tighten the set screw.
7. Slide the cover over the backplate collar. Thread the fixture collar onto the backplate collar to tighten.

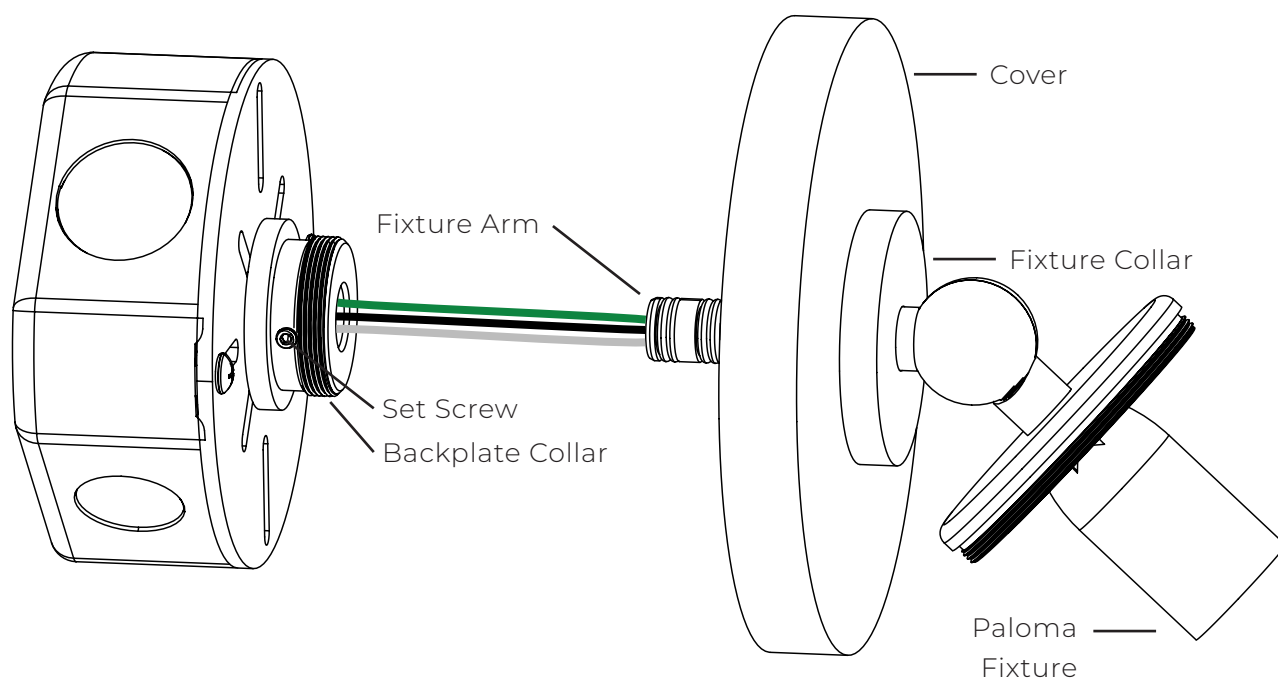

8. Thread the bulb into the socket.
9. Thread the shade onto the socket collar.
10. Loosen the wing nut to adjust the up-down rotation angle of the shade. Tighten the wing nut to lock the angle.

